

POLARJET® PJ 303

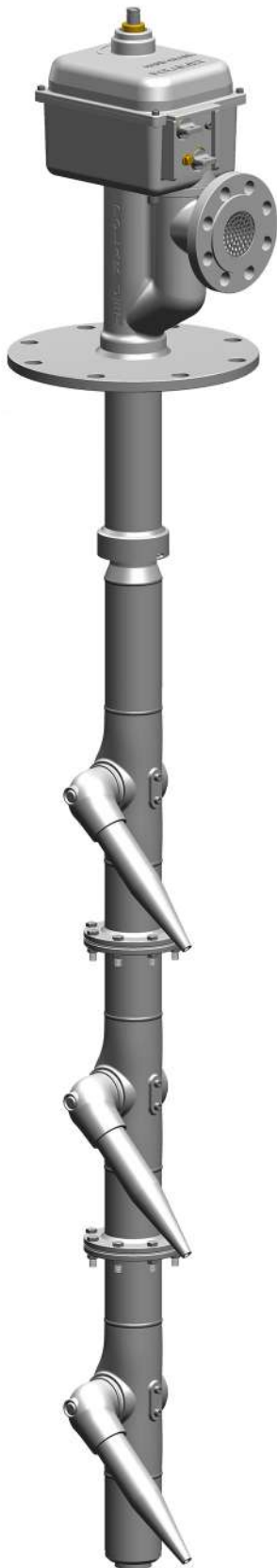

The Polar Jet® PJ 303 is a fully programmable, multi-stage, single nozzle Tank Cleaning machine equipped with pitch and speed control. This model can be supplied with 2, 3, 4, or more nozzles according to the specific cleaning requirements of the tank configuration.



Nozzle movement is fully controlled by the integrated turbine driven control unit, which controls both the vertical pitch and rotation speed.



Nozzle movement is, in principle, a controlled rotation in the horizontal plane, combined with a slow, controlled vertical movement. This means that the nozzle performs helical patterns.



The PJ 303 comes with operator-friendly controls to set both vertical Pitch and rotation Speed. There are two Speed Settings and three Pitch Settings of approximately 1.5, 3 and 7 degrees providing six basic programs.



Angle adjustment allows pre-setting of the Pitch at the start of either the upward or downward cycle for optimal cleaning of specific areas such as bottom only or side only cleaning requirements.



Polarmarine provide in-house Shadow Diagrams using 3-Dimensional CAD for model Selection, Quantity, Positioning and Main Pipe Lengths to optimize cleaning coverage per unit. The Shadow Diagrams are made according to DNV ETC, Effective Tank Cleaning.



Standard material is according to Stainless Steel 316L. As optional with higher grade, Stainless Steel with Molybdenum equal or higher than 2.5% is also offered.

DATA SHEET POLAR JET® PJ 303

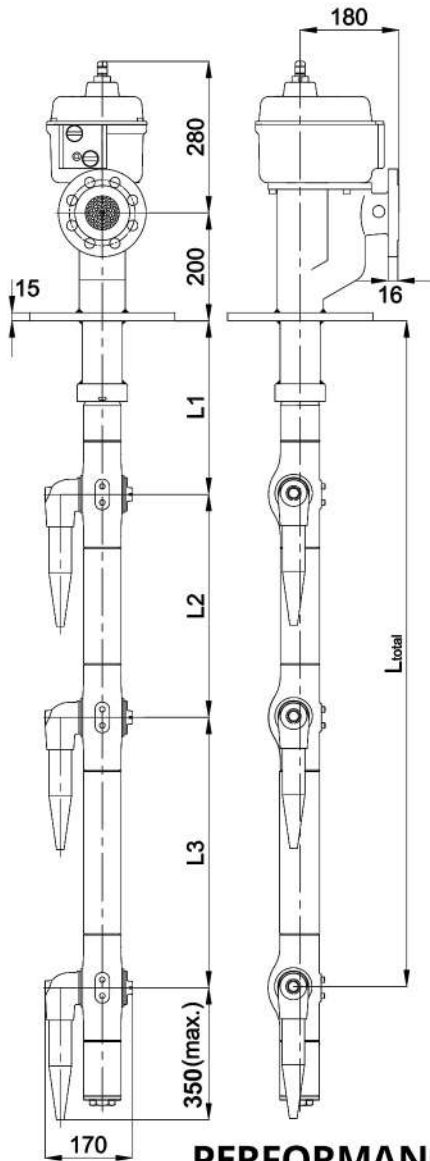

SMALLEST DECK OPENING 180mm

INLET FLANGE

JIS STANDARD

PCD	120mm
8 Holes	Ø 19mm

DIN STANDARD

PCD	125mm
4 Holes	Ø 19mm

ANSI STANDARD

PCD	4 3/4 in
4 Holes	Ø 3/4 in

APPROX. WEIGHTS

L (m)	WEIGHT (kg)
1.0	49
2.0	56
3.0	63
4.0	70
5.0	77

Note: Add 7 kgs. for every meter length

DECK FLANGE

JIS STANDARD

OD	320mm
PCD	280mm
8 Holes	Ø 23mm

DIN STANDARD

OD	340mm
PCD	295mm
12 Holes	Ø 23mm

ANSI STANDARD

OD	13 1/2 in
PCD	11 3/4 in
8 Holes	Ø 7/8 in

SHIPYARD SUPPLY

- DECK FLANGE CONN.
- GASKETS
- STUDS
- NUTS
- WASHERS

PERFORMANCE DATA FOR POLAR JET® PJ 303

PRESSURE, NOZZLE DIAMETER, THROUGHPUT AND JET LENGTH

(Note: Data below is for each nozzle only)

PRESSURE	NOZZLE: Ø 8mm		NOZZLE: Ø 9mm		NOZZLE: Ø 10mm		NOZZLE: Ø 12mm		NOZZLE: Ø 14mm		NOZZLE: Ø 16mm	
	BAR	m³/h	METER	m³/h	METER	m³/h	METER	m³/h	METER	m³/h	METER	m³/h
12	6.5	19.5	10.0	20.5	13.0	21.5	19.0	25.0	27.0	26.5	35.0	28.5
11	6.0	18.5	9.0	20.0	12.0	20.5	18.0	24.5	26.0	26.0	33.5	27.5
10	5.5	18.0	8.0	19.0	11.0	20.0	17.0	23.5	24.0	25.5	32.0	27.0
9	5.0	17.0	7.5	18.0	10.5	19.0	16.0	22.5	23.0	24.5	30.0	26.0
8	4.5	16.0	7.0	17.0	10.0	18.0	15.0	21.5	22.0	23.5	28.5	25.0
7	4.0	15.0	6.0	16.0	9.0	17.0	14.0	20.5	20.0	22.5	27.0	24.0
6	3.5	14.0	5.5	15.0	8.0	16.0	13.0	19.5	19.0	21.5	25.0	23.0

Note: Polarmarine can provide intermediate nozzle sizes based on customer's machine performance requirement. On the other hand, intermediate nozzle sizes could refer to performance data of the larger nozzle size (For instance, Ø 15.2 mm needs to apply performance data of Ø 16 mm).

MATERIAL SPECIFICATIONS POLAR JET® PJ 303

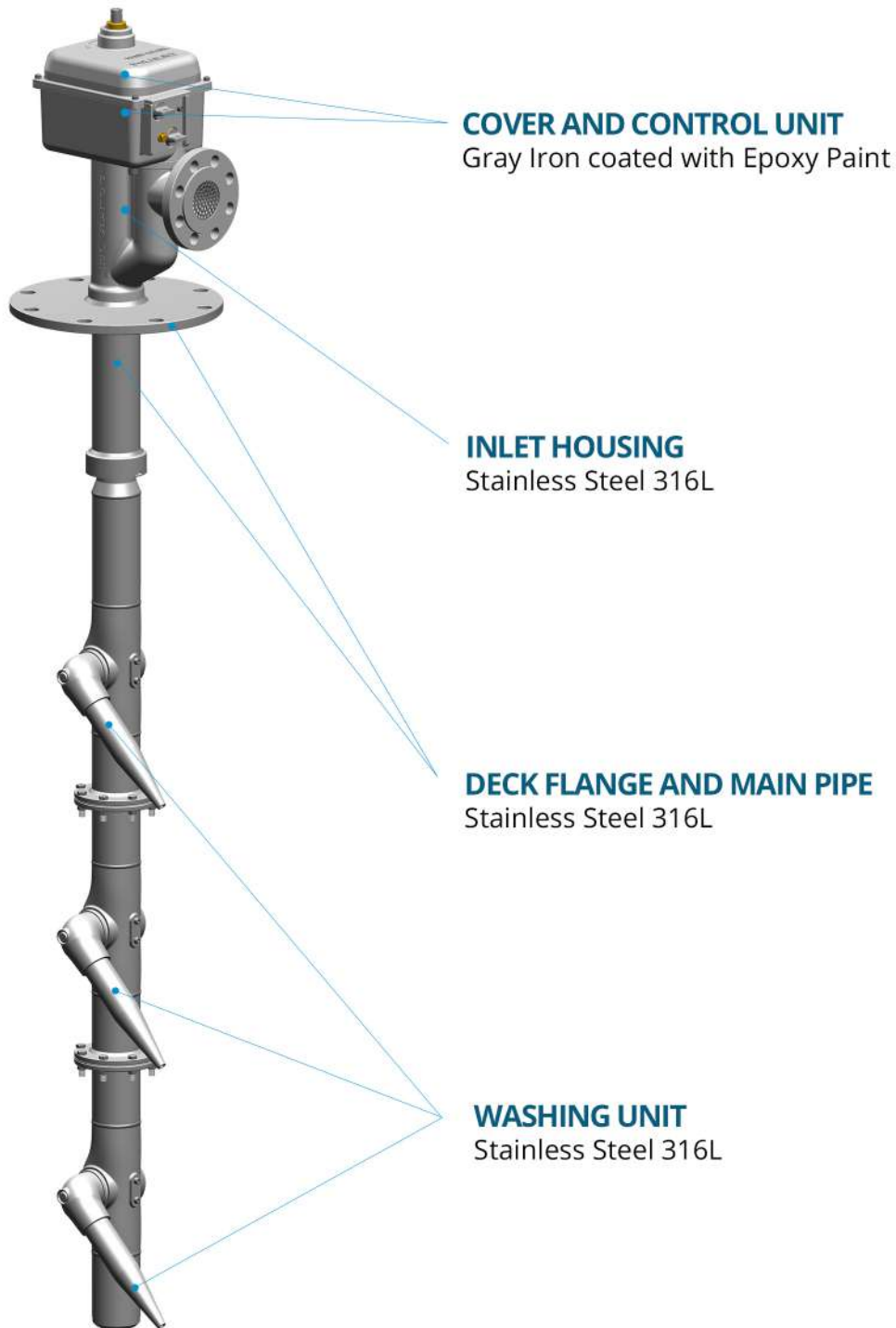

*Paint specification is Polarmarine Standard. Modification of paint specification is subject for additional charge.
Also available with **Stainless Steel 316 Control Unit and Cover upon request and subject to additional charge.